

10. Install the take-up cover seal and lower the front cover.
11. Turn the system on.
12. Using the AVDIAG program check the operation of the punch. Under engine primitives exercise all the punch positions:
 - a. Punch Home
 - b. Punch Clamp
 - c. Punch Punch
13. Reboot the system and run a customer file with the punches turned on. Ensure that the punches work properly.

4.5.4 take-up Cutter Assembly

Tools Required: 5/16" nut driver, 5/64" allen wrench, 5/32" allen wrench

Remove:

1. Remove the lower front cover. See Section 4.4.1, Lower Front Cover, above.
2. Remove the take-up cover seal. See Section 4.4.2, Take-up Cover Seal, above.
3. Remove the outer take-up nip drive assembly. See Section 4.5.1, Outer Take-up Drive Assembly, above.
4. Remove the foam blocks to the left and right of the light shield.
5. Using a 5/32" allen wrench, remove the eight (8) screws from the take-up platform support bracket. Refer to Figure 4-12.
6. Disconnect the cutter motor/switch connector. Refer to Figure 4-14.
7. Open the bottom and top side doors on the right side of the imagesetter. Refer to Figure 4-8. Locate the manual cutter knob. Refer to Figure 4-14.
8. Using a 5/64" allen wrench, remove the two (2) set screws from the manual cutter knob. Refer to Figure 4-14. Remove the shaft.
9. Using a 5/16" nut driver, remove the four (4) hex screws on the left side of the cutter as follows:
 - a. First remove the two (2) screws securing the left light seal to the cutter.
 - b. Second, while supporting the cutter assembly with one hand, remove the two (2) remaining screws securing the cutter to the upper structure.
 - c. Tilt the left side of the cutter out first, then slide the assembly from the system.

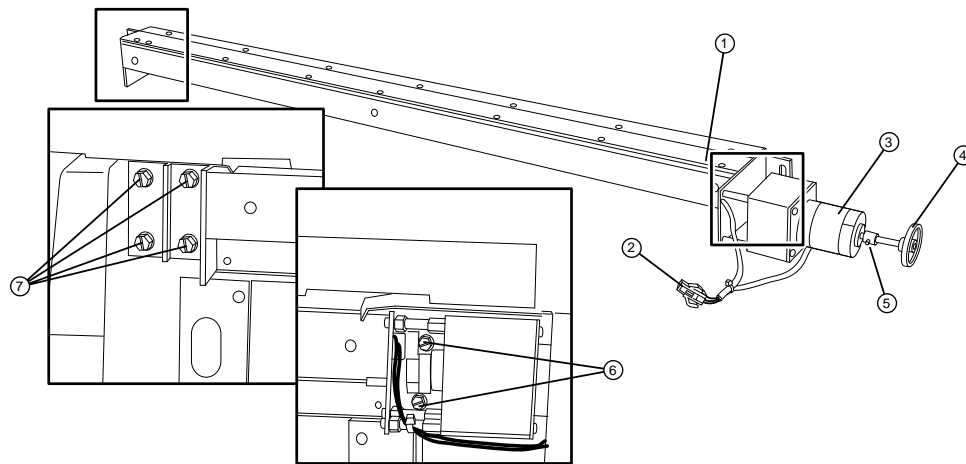

Figure 4-14 Take-up cutter assembly.

- ①—Take-up cutter assembly. ②—Switch connector. ③—Cutter motor.
- ④—Manual cutter knob. ⑤—Two set screws.
- ⑥—Two hex screws (right side). ⑦—Four hex screws (left side).

Replace:

1. Reverse the above removal procedure.

4.5.5 Flappers

Tools Required: Long bladed phillips screwdriver, 5/32" allen wrench, 5/16" socket wrench, 3/8" nut driver

Remove:

1. Remove the lower front cover. See Section 4.4.1, Lower Front Cover, above.
2. Remove the take-up cover seal. See Section 4.4.2, Take-up Cover Seal, above.
3. Remove the outer take-up nip drive assembly. See Section 4.5.1, Outer Take-up Drive Assembly, above.
4. Remove the foam blocks from the light seal on the left and right side of the imagesetter.
5. Remove the take-up punch assembly. See Section 4.5.3, Take-up Punch Assembly, above.
6. Flip the four (4) locking latches up on the light shield on the right side and remove the shield. Do the same on the left side of the system. Refer to Figure 4-15.