

## Appendix B

# Spare Parts

### On-Line Processor (OLP)

The following lists and illustrates spare parts for the 36/44 P and OLP.

## Avantra 36/44 OLP Parts

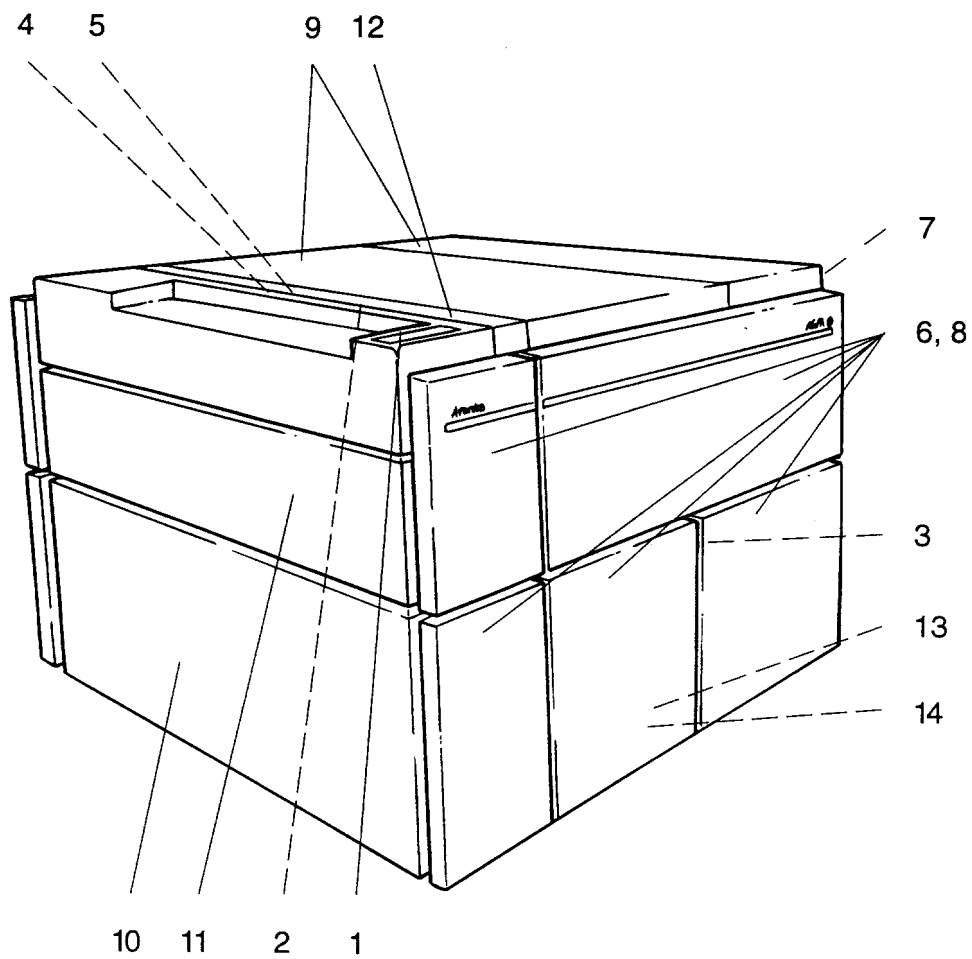

**Avantra 36/44 OLP Parts List**

1	LU+0510Y013100	Control panel complete (P version)
	LU+0507Y013101	Control panel complete (OLP version)
2	LU+2621Y001001	Keyboard cable 2.75 m (P version)
	LU+2621Y001006	Keyboard cable 3.00 m (OLP version)
3	LU+6203X000800	Magnetic lock
4	LU+1451X000100	Paper path sensor
5	LU+2621Y011001	Wiring hamess l/P sensors (P version)
	LU+2621Y010901	Wiring harness l/P sensors (OLP version)
6	LU+3621E290144	Side plate, left, upper
	LU+3621E291440	Side plate, left, upper, front
	LU+3621E290840	Side plate, left, lower, front
	LU+3621E290940	Side plate, left, rear, lower
7	LU+3621E291040	Side plate, rear, lower
	LU+3601E290140	Side plate, rear, upper
8	LU+3621E290244	Side plate, right, upper
	LU+3621E291340	Side plate, right, upper, front
	LU+3621E290540	Side plate, front, right lower
	LU+3621E290640	Side plate, middle, right, lower
	LU+3621E290740	Side plate, rear, right, lower
9	LU+3621E292142	Top cover, rear
	LU+3621E292042	Top cover middle
10	LU+3621E290440	Front plate
11	LU+3621E300140	Cassette
12	LU+3621E300342	Cover plate for I/P sensors
13	LU+3601E600200	Drip tray, left
	LU+3601E600300	Drip tray, right
14	LU+3615D600200	Chemicar cpl.
15	LU+3601E290715	Film basket, comp.

## Avantra 36/44 OLP Parts

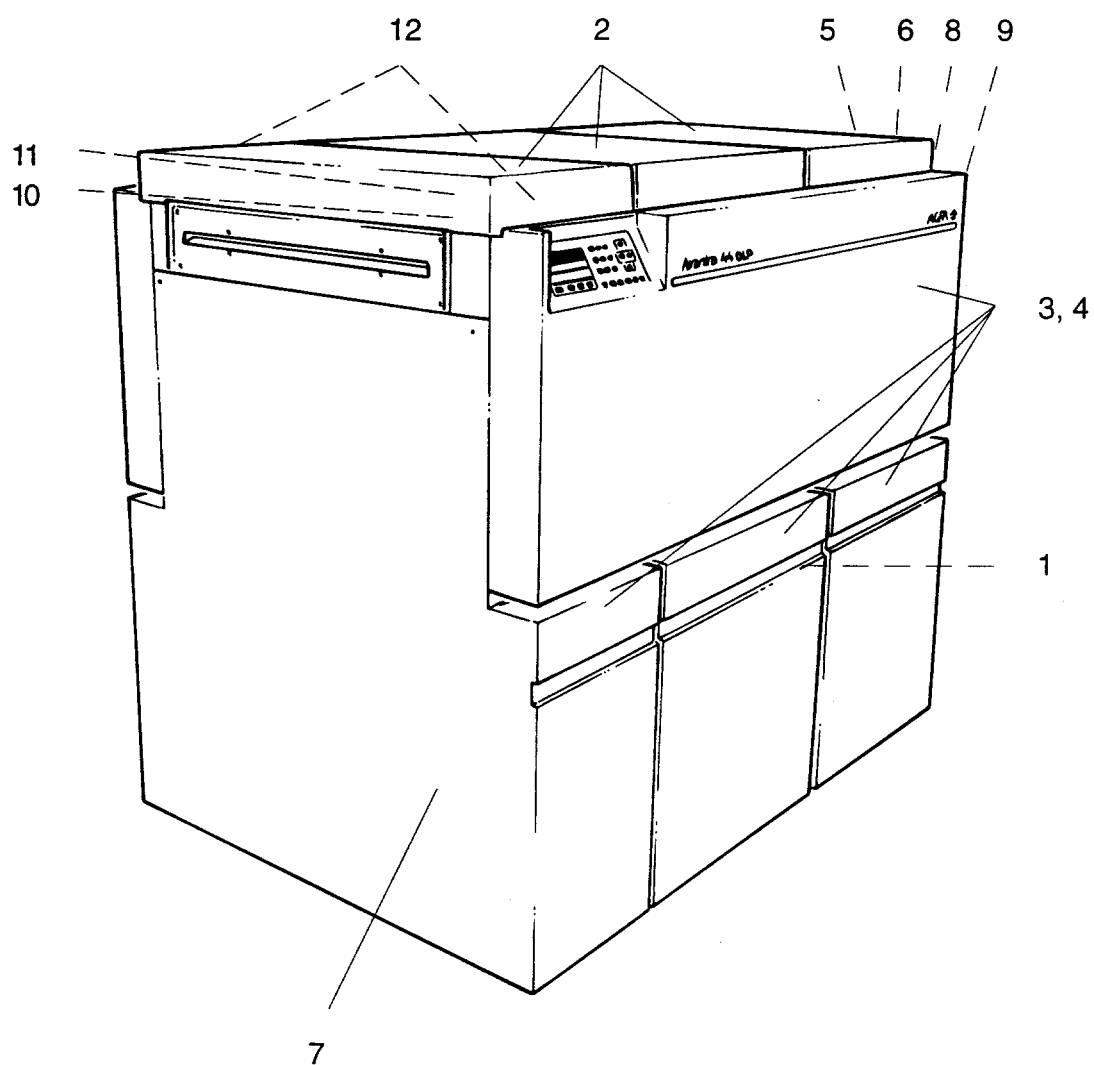

**Avantra 36/44 OLP Parts List**

1	LU+6203X000800	Magnetic lock
2	LU+3611E291842	Top cover, rear
	LU+3611E291942	Top cover, middle
	LU+3611E290342	Top cover, front
3	LU+3611E290244	Side plate, right, upper
	LU+3611E290540	Side plate, right, front, lower
	LU+3611E290640	Side plate, right, middle, lower
	LU+3611E290740	Side plate, right, rear, lower
4	LU+3611E290144	Side plate, left, upper
	LU+3611E290840	Side plate, front, left lower
	LU+3611E290940	Side plate, rear, left, lower
5	LU+3601E290715	Film basket, comp.
6	LU+3601E290140	Side plate, rear, upper
	LU+3611E291040	Side plate, rear, lower
7	LU+3611E290400	Front plate
8	LU+2601Y010201	Wiring harness output sensor
9	LU+1451X000100	Jam sensor
10	LU+1441X000300	Reed switch
11	LU+1442X000100	Magnet for red switch
12	LU+2211X000100	Safety switch, front box

## Avantra 36/44 OLP Cassette Parts

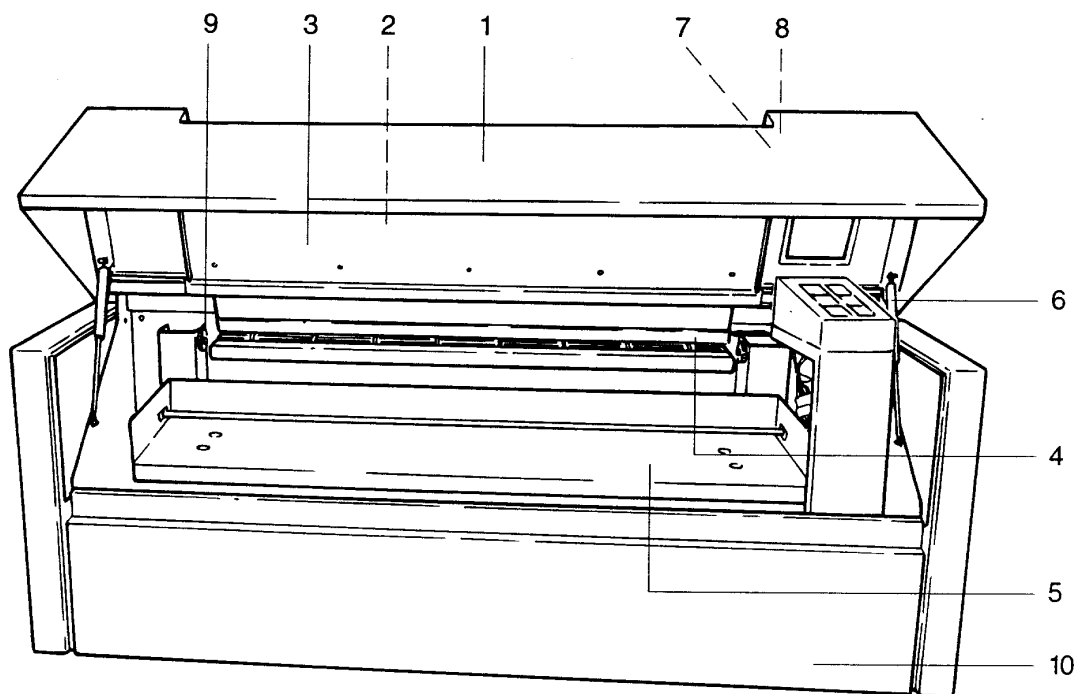

### **Avantra 36/44 OLP Cassette Parts List**

1	LU+3621E300242	Cassette cover
2	LU+3621E300742	Feed table upper
3	LU+3621E300602	Feed table lower
4	LU+3621E301134	Stop bar
5	LU+3621E300834	Bottom plate for cassette
6	LU+6221X000203	Gas damper for cassette cover
7	LU+6221X000102	Gas damper for feed table
8	LU+1351Z060401	Slide bearing Ø6/Ø4 x 4
9	LU+1201Z201505	Gear wheel
10	LU+3621E300142	Cassette bottom

## Avantra 36/44 OLP Feed Rack Parts

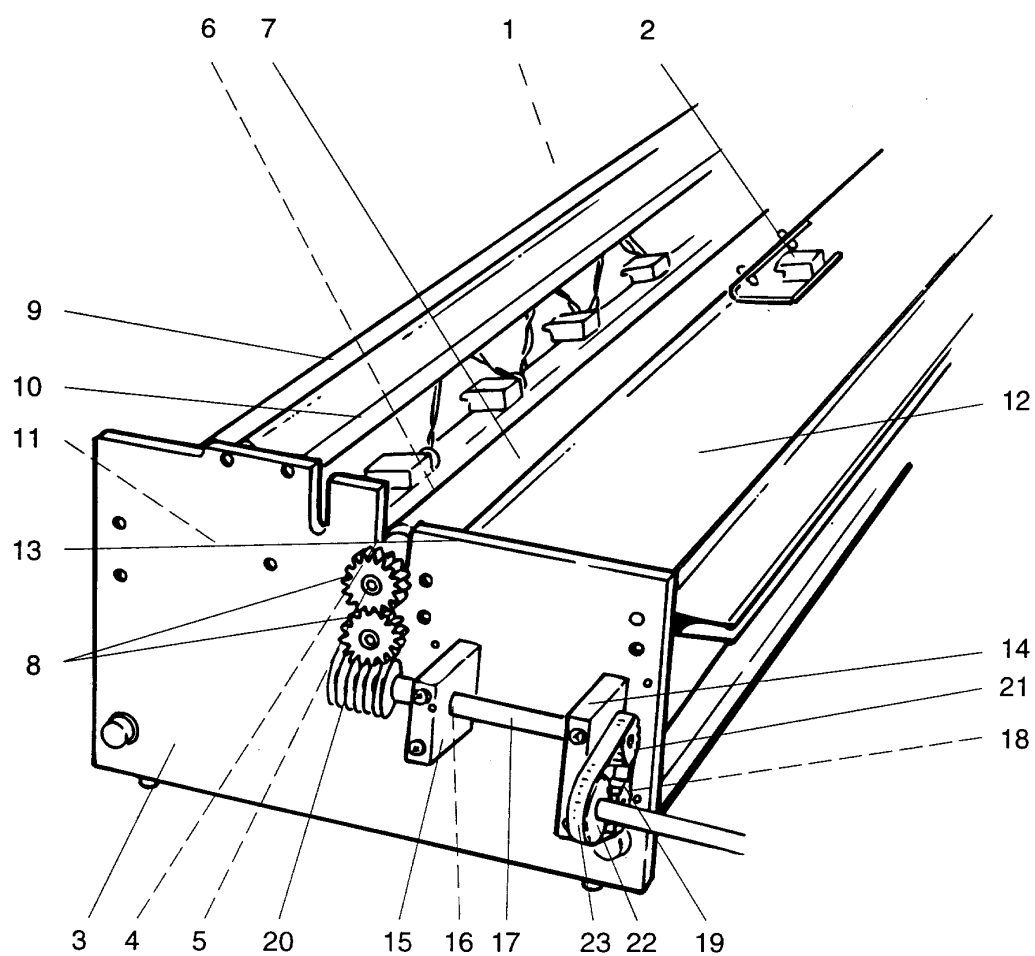



**Avantra 36/44 OLP Feed Rack Parts List**

1	LU+3611E300234	Cover for frontbox
2	LU+1451X000100	Paper path sensor
3	LU+3022Z000701	Side plate (left and right)
4	LU+1351Z000501	Bearing for roller PBTP (upper)
5	LU+1351Z000101	Bearing reamed to 10.2mm
6	LU+1410Z041404	Rubber roller Ø25.0 15/35 (lower)
7	LU+1414Z241404	Heavy roller Ø25.0 15/35
8	LU+1282Z161501	Gear M = 1.5/Z = 16/Ø10H7
9	LU+3611E710100	Guide, 91mm FB
10	LU+3611E710200	Curved guide, FB
11	LU+3611E710300	Guide, 132mm FB
12	LU+3611E710400	Guide, 135mm FB
13	LU+2131Z000103	Spring for guide
14	LU+1361Z004701	Bearing block, front
15	LU+1361Z004601	Bearing block, rear
16	LU+1351Z000101	Bearing, reamed to 10.2mm
17	LU+1301Z000805	Drive shaft
18	LU+1331Z000104	Bushing Ø6/Ø10 x 16
19	LU+1253Z160502	Tension roller
20	LU+1221Z011503	Worm for drive shaft
21	LU+1252Z200501	Drive belt pulley
22	LU+1252Z240502	Drive belt pulley
23	LU+6101X000400	Belt

## Avantra 36/44 OLP Tank Parts

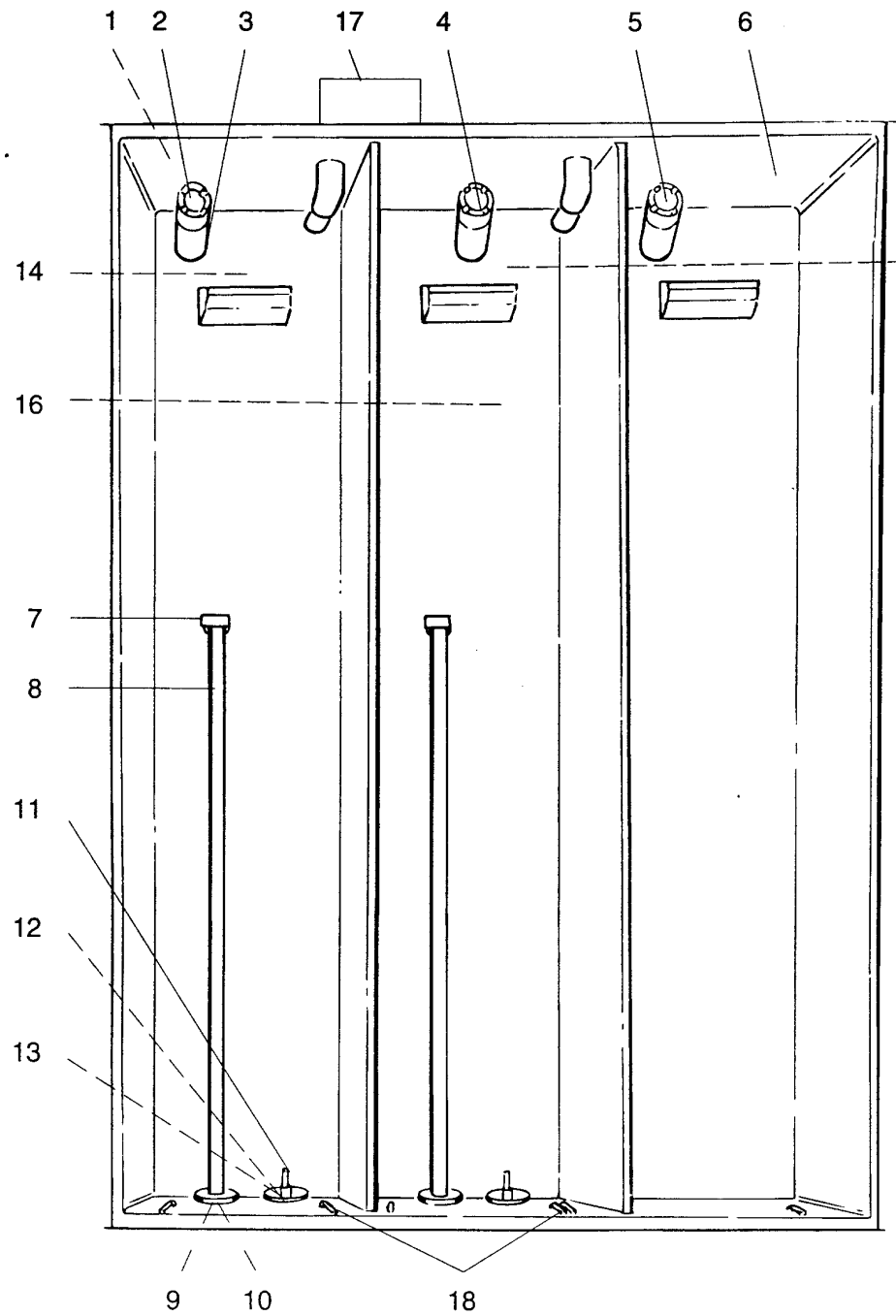

**Avantra 36/44 OLP Tank Parts List**

1	LU+3219Z000101	Key for overflow pipes
2	LU+3201Z321901	Overflow pipe, dev.
3	LU+8181X000800	O-ring 19.2 x 3.0
4	LU+3202Z321901	Overflow pipe, fixer
5	LU+3203Z321901	Overflow pipe, wash
6	LU+3601E120100	Tank with fittings
7	LU+3041Z000101	Fixation block for heater element dev + fix tank
8	LU+2201Y000201	Heater element 1000/500 W 230 V dev + fix tank
9	LU+3230Z000401	Union nut Ø16.3 for heater element
10	LU+8181X000700	O-ring 15.88 x 2.62 for heater element
11	LU+2101Y000301	Temperature sensor PT 500 dev + fix tank
12	LU+8181X000200	O-ring 7.3 x 2.4, nitril for PT 500
13	LU+3230Z000301	Union nut Ø8.1 for PT 500
14	LU+3031Z001301	Lid for drain, red
15	LU+3032Z001301	Lid for drain, blue
16	LU+3601E120300	Cover for dev & fix tank
17	LU+2304Y000101	Fan with wiring
18	LU+2301Y000101	Level sensor
	LU+3601E600100	Drip tray for racks (NOT SHOWN)

## Avantra 36/44 OLP Right Side View Parts

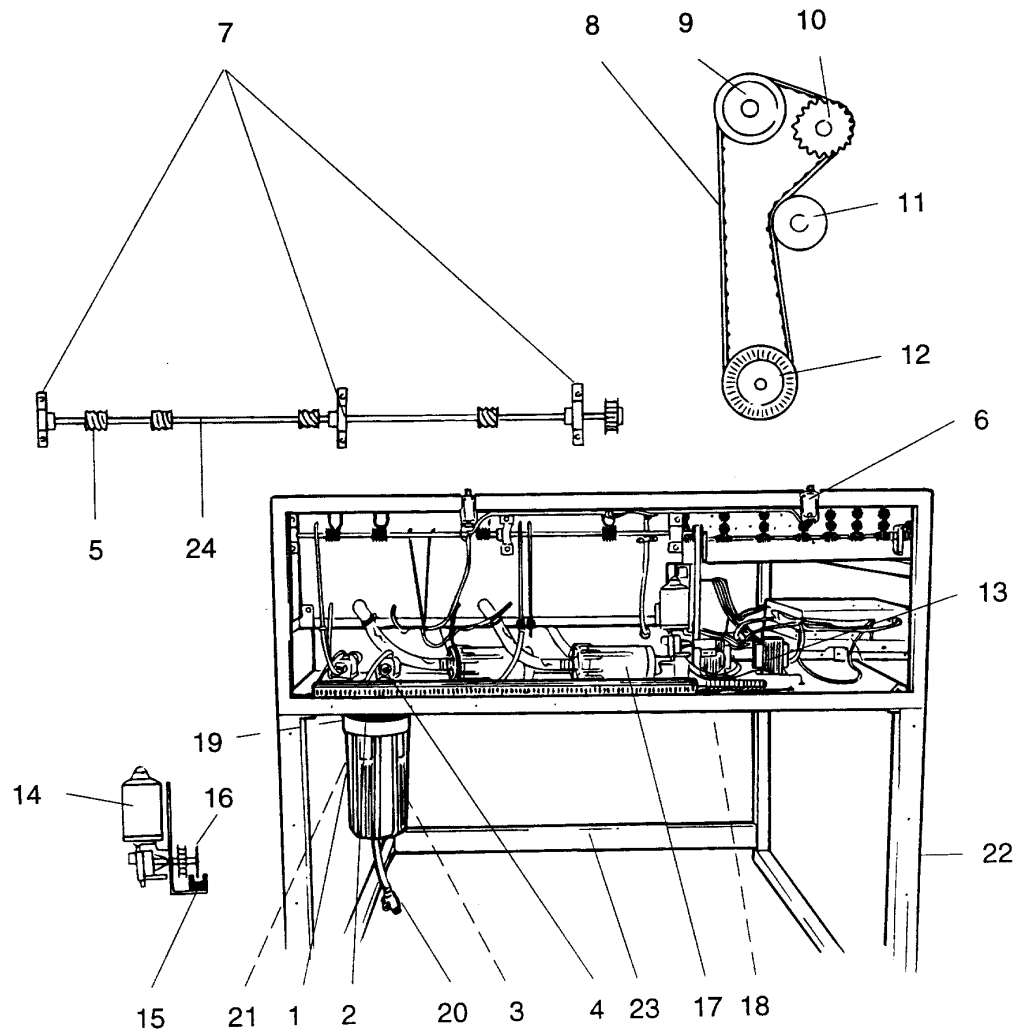

**Avantra 36/44 OLP Right Side View Parts List**

1	LU+6900X000500	Filter housing complete
2	LU+8181X001600	O-ring 98.02 x 3.50
3	LU+6909X000700	Cartridge
4	LU+0201X000801	Replenish pump for dev + fix
5	LU+1221Z010201	Worm
6	LU+2211X000200	Safety door switch
7	LU+6311X000200	Bearing
8	LU+6101X001200	Drive belt 10T5, L=630mm
9	LU+1252Z240502	Drive belt pulley
10	LU+1251Z200501	Drive belt pulley T5/21/20 without flange
11	LU+1241Z000102	Tension roller
12	LU+1252Z270501	Drive belt pulley T5/21/27
13	LU+1501X000600	Transformer
14	LU+0104X000500	Motor 24 V
15	LU+1461X000200	Opto interruptor
16	LU+1462X000200	Slotted disc 60 holes
17	LU+0201X000301	Circulation pump for dev + fix
18	LU+3230Z002801	Pipe for repl., Ø10/Ø7
19	LU+7341X252001	Ball valve,1 V311250, Ø25
20	LU+7342X121221	Valve
21	LU+2701	Wrench for filter
22	LU+3621E310000	Stand complete (P version)
	LU+3611E310000	Stand complete (OLP version)
23	LU+3601E310240	Cross-member
24	LU+1301Z001202	Drive shaft (P version)
	LU+1301Z000201	Drive shaft (OLP version)

## Avantra 36/44 OLP Control Panel Parts

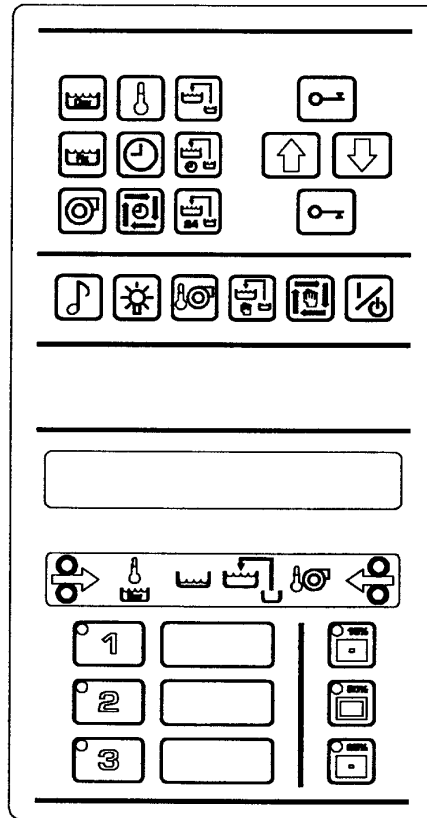

## Avantra 44 OLP Control Panel

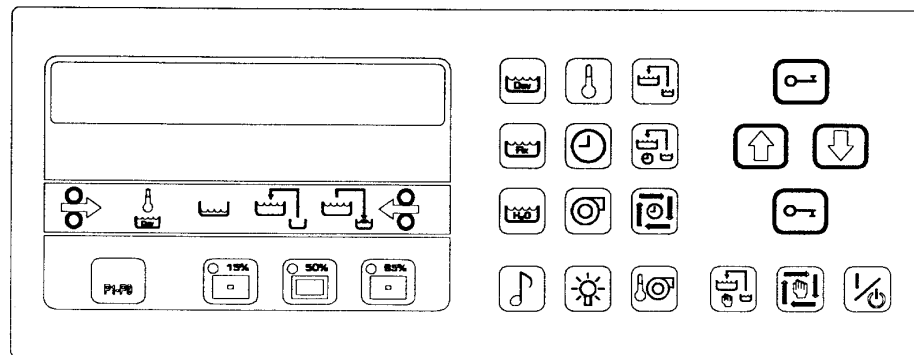

## **Avantra 36/44 OLP Control Panel Parts List**

LU+0510Y013100	Control panel (P version) Keyboard (LU+2621X001700) (P version)
LU+6205Y010200	Board, control panel
LU+6205Y010000	EPROM
LU+0507Y013100	Control panel (OLP version) Keyboard (LU+2621X001600) (OLP version)
LU+6205Y010300	Board, control panel
LU+6205Y010000	EPROM
LU+2631Y001201	Internal keyboard cable

## Avantra 36/44 OLP Rack Spare Parts

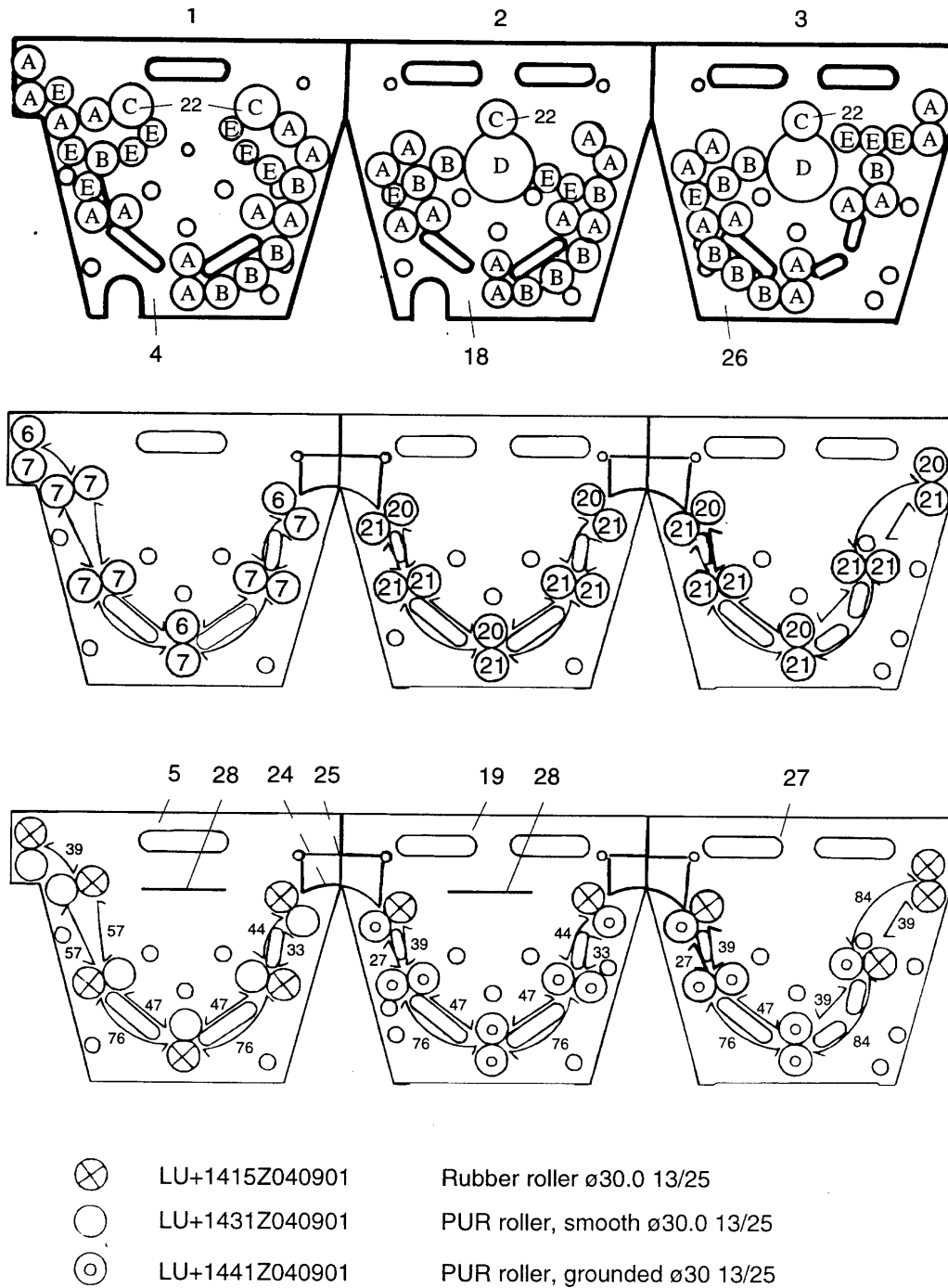



## Avantra 36/44 OLP Rack Spare Parts List

1	LU+3601E210000	Developer rack
2	LU+3601E222000	Fixer rack
3	LU+3601E230000	Wash rack
4	LU+3601E210100	Side plate, right dev.
5	LU+3601E210200	Side plate, left dev.
6	LU+1351Z000104	Bearing, upper, reamed to 10.5mm
7	LU+1351Z000102	Bearing, lower, reamed to 10.2mm
8	LU+3111Z000104	Distance bar 20mm
9	LU+2008Z000301	Guide 27mm
10	LU+2009Z001601	Guide 33mm
11	LU+2022Z000301	Guide 39mm
12	LU+2009Z001701	Guide 47mm
13	LU+2009Z001801	Guide 57mm
14	LU+2019Z001301	Curved guide 39mm
15	LU+2019Z001401	Curved guide 44mm
16	LU+2019Z001501	Curved guide 76mm
17	LU+2020Z000101	Curved guide 84mm
18	LU+3601E220100	Side plate, right, fixer
19	LU+3601E220200	Side plate, left, fixer
20	LU+1351Z000103	Bearing, upper, Ø10.5
21	LU+1351Z000101	Bearing, lower, Ø10.2
22	LU+1331Z001001	Bushing
23	LU+1331Z000101	Bushing for idler
24	LU+3601E210403	Crossover for dev/fix + fix/wash
25	LU+6292X000100	Spring for crossover
26	LU+3601E230100	Side plate, right wash
27	LU+3601E230200	Side plate, left wash
28	LU+3034Z000301	Lid, SST
A	LU+1201Z201503	Gear, M= 1.5/Z = 20/Ø 10H7
B	LU+1201Z201504	Gear, M= 1.5/Z = 20/Ø 10.2
C	LU+1211Z160201	Adapter gear M = .5/2 Z = 20/6 B = 65
D	LU+1201Z421505	Gear, M= 1.5/Z = 42/Ø 10.2/B = 23
E	LU+1282Z161502	Gear, M= 1.5/Z = 16/Ø 10H7

## Avantra 36/44 OLP Dryer Spare Parts

⊗ Heavy Rubber roller ø25.0 15/35

⊖ Rubber ø25.0 15/35

○ PUR/Teflon roller ø25 15/35

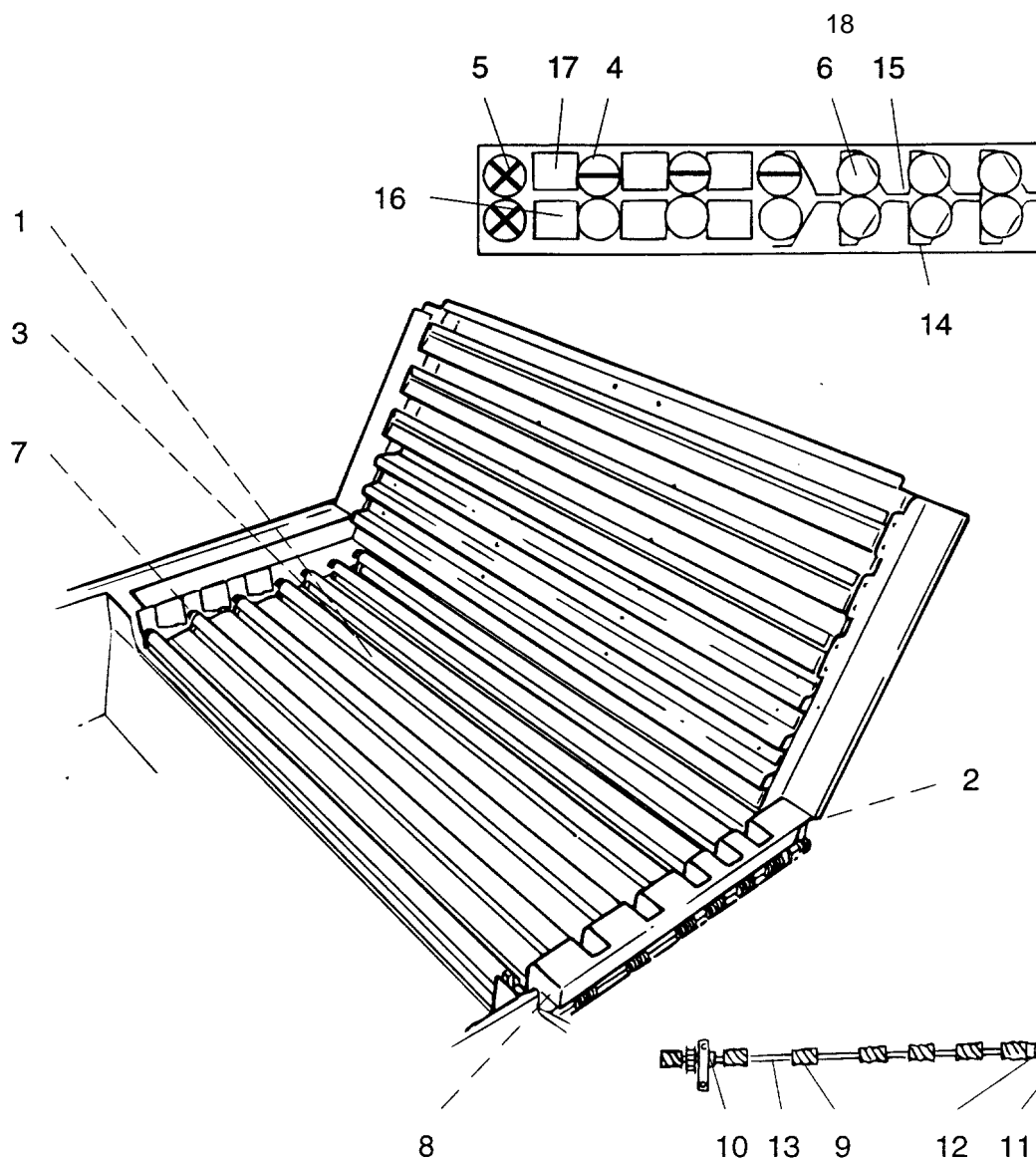

## Avantra 36/44 OLP Dryer Parts List

1	LU+0401X000100 W	Heating element 220 V, 2 x 750
2	LU+0301X001000	Dryer fan
3	LU+2101Y000401	Temperature sensor PT500
4	LU+1410Z041404	Rubber roller Ø25.0 15/35
5	LU+1414Z241404	Heavy rubber Ø25.0 15/35
6	LU+1450Z041404	PUR/teflon roller Ø25/ 15/35
7	LU+1351Z000601	Thrust bearing, square
8	LU+1282Z161501	Gear, M = 1.5/Z = 16/ Ø10H7
9	LU+1221Z011503	Worm for drive shaft dryer
10	LU+1351Z201007	Thrust bearing
11	LU+1361Z004801	Bearing block
12	LU+6321X101510	Bearing bronze with collar
13	LU+1301Z000207	Drive shaft dryer
14	LU+3601E240501	Triple guide lower comp.
15	LU+3601E240601	Triple guide upper comp.
16	LU+3601E240711	Air duct lower
17	LU+3601E240811	Air duct upper
18	LU+2201Z000602	Exit guide

## Electronics (upper) Spare Parts

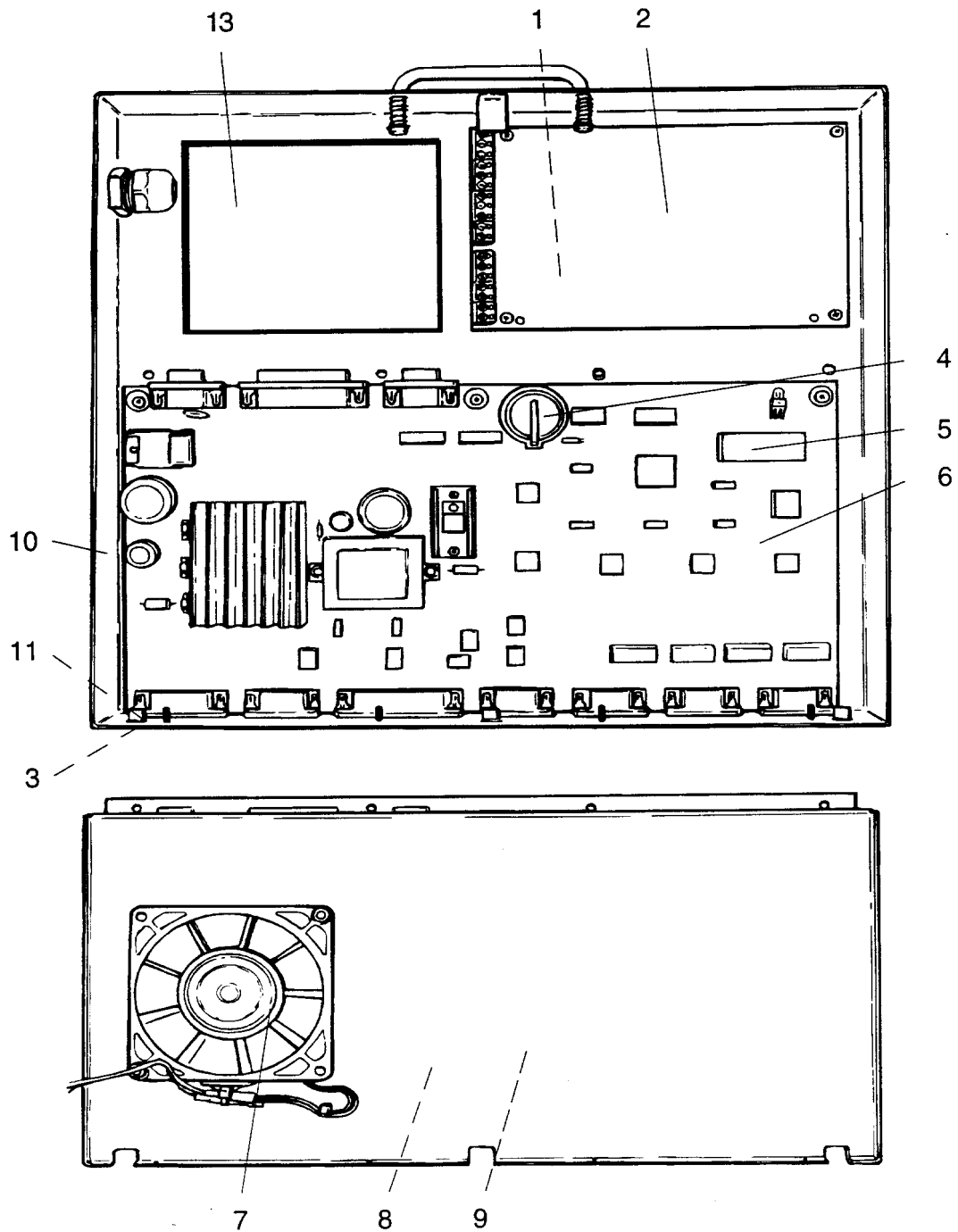

**Electronics (upper) Spare Parts List**

1	LU+2415X100000	Fuse, 10AT, 5 x 20mm
2	LU+5202Y000100	LUTH motor board, LMB 02
3	LU+2416X006000	Fuse, 600 mAF, 5 x 20mm
4	LU+1311X000100	Lithium cell, 3 Volt
5	LU+6301Y840000	EPROM 36F44V02R02 (P version)
	LU+6305Y010000	EPROM 36A44V02R03 (OLP version)
6	LU+6301Y000501	LUTH computer board, LCB 01 with anti-loop
7	LU+2304Y000301	Fan, 12V
8	LU+4121Z000501	Bracket for plugs
9	LU+4121Z000401	Shield for electronics
10	LU+4101Z000301	Upper part electronics
11	LU+2601Y004201	Fuse holder
12	LU+2621Y007003	Interface cable (OLP version only)
13	LU+5305Y000101	LUTH rectifier board, LRB 01

## Electronics (lower) Spare Parts

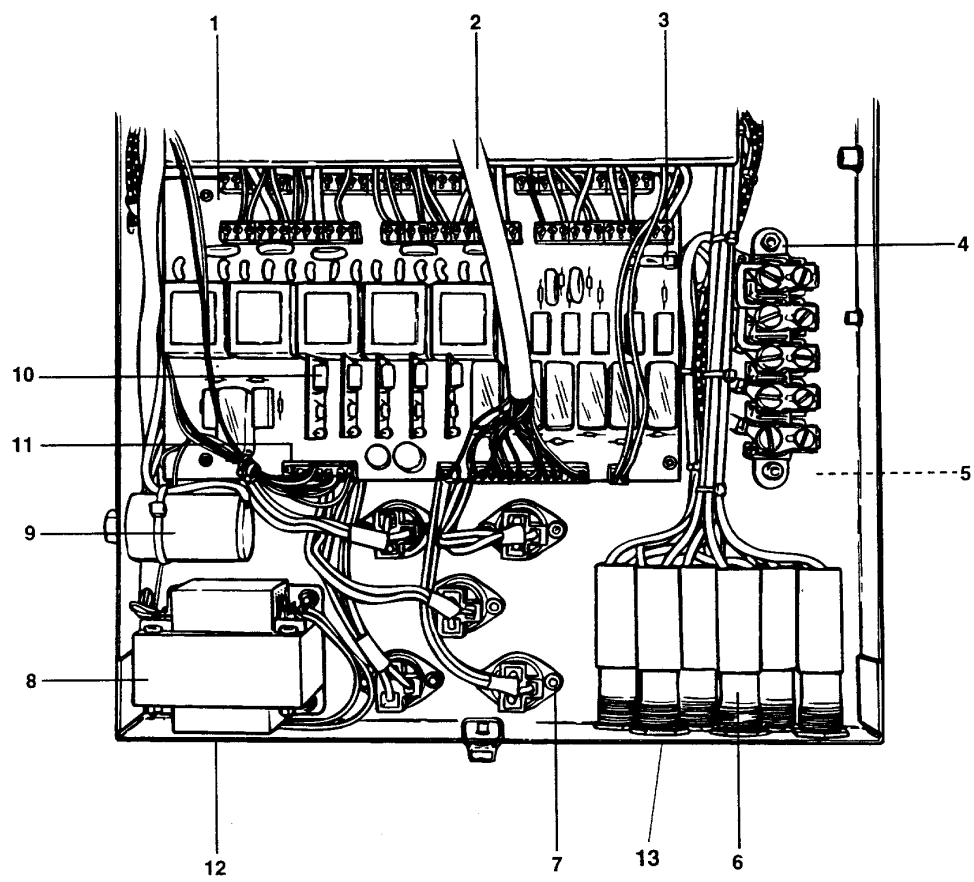

**Electronics (lower) Spare Parts List**

1	LU+5111Y000200	LUTH power board, LPB 01
2	LU+2621Y003201	Interconnection cable
3	LU+2415X003200	Fuse, 315 mAT, 5 x 20mm
4	LU+3111X000800	Terminal strip, 5 circuit
5	LU+4121Z000201	Protective plastic shield (NOT SHOWN)
6	LU+2401X000100	Fuse holder, complete
7	LU+3848	Power triac, 25 A
8	LU+1501X000300	Transformer
9	LU+2121X000400	Motor capacitor
10	LU+3847	Trigger Board
11	LU+2501Y003801	Molex, 2-wire
12	LU+4101Z000401	Lower part electronics box
13	LU+2411X020000	Fuse 2A, 6 x 32
	LU+2411X100000	Fuse 10A 6 x 32mm
	LU+2411X063000	Fuse 6.3A, 6 x 32mm
	LU+2411X150000	Fuse 15A, 6 x 32mm